

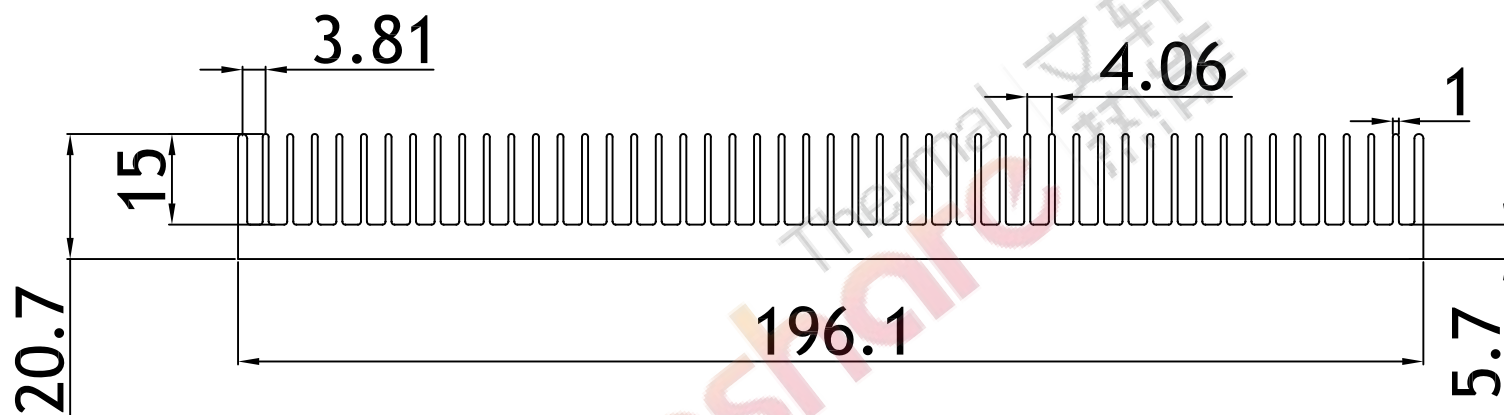

REVISIONS			
REV/批号	DESCRIPTION	APPROVE	DATE



- 注:
1. 材质: AL6063-T5, 硬度10-13°
 2. 表面不可有手感刮碰伤、线条。
 3. 截面积: 1867.0984MM², 米重: 5.08Kg
 4. 标*号为QC重点检验尺寸
 5. 1米内的扭曲度0.5以内
 6. 模号: Y3857

REVISED:	1.0
MATERIAL:	AL 6063-T5
TOLERANCE UNLESS NOTED	
Linear:	0-10±0.15 10-30±0.2 30-50±0.3 50-100±0.4
ANGLE:	±0.5°

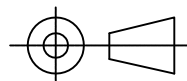

TITLE: 铝挤型				
Part Number: 03-200353-10				
APPROVE	CHK'D	DRAW	DATE	UNITS
		曹开强	2015-01-13	mm
SCALE			1:1	